

# STANDIVARIUS

Pairing your replacement USB dongle with Solo X keyboard

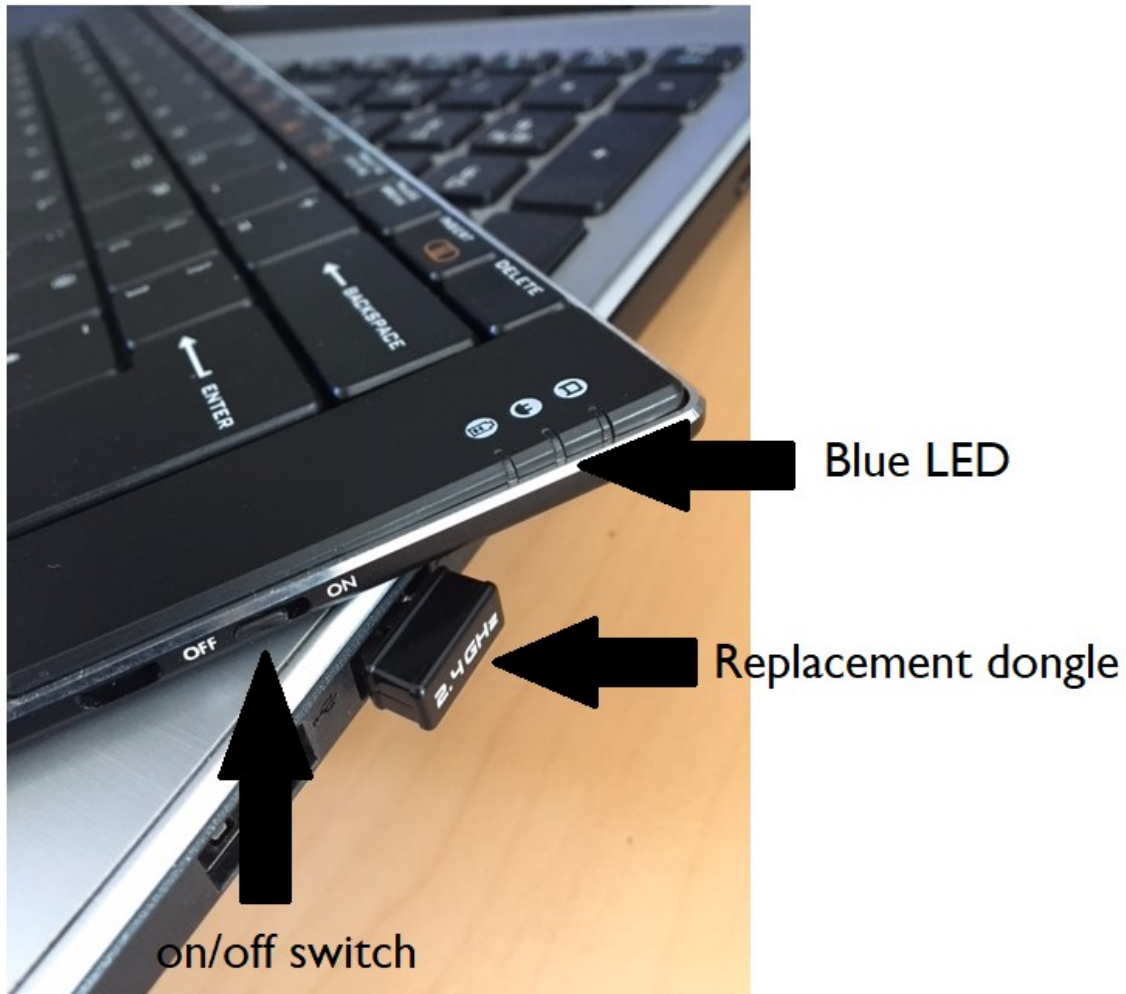

If the red LED is on, then recharge the keyboard.

## Pairing instructions:

1. Switch off the keyboard using the switch on the right-hand edge.
2. Insert replacement dongle into a spare USB port on your laptop.
3. Place Solo X keyboard directly adjacent to the replacement dongle.
4. Place Solo X keyboard directly adjacent to the replacement dongle.
5. Switch on keyboard using the switch on the right-hand edge. As the blue LED flashes press the **Esc** and **K** keys simultaneously and release.